

B.S. ATWOOD

Base Line of Location of Old Colony Railroad.
P.C.

Easterly side line of location

957. Area = .36 Ac

952.2

3712.2888

3712.2888

W.E. TRUFANT

B.S. ATWOOD

C.E. WHIDDEN

O.C. R.R. Co.

PLAN OF LAND IN WHITMAN
TO BE CONVEYED TO THE
OLD COLONY R.R. CO.
BY
B.S. ATWOOD

Scale 1" = 100'

March, 1906.

June 6 1906

806th #



W. B. Stout

200 200 200

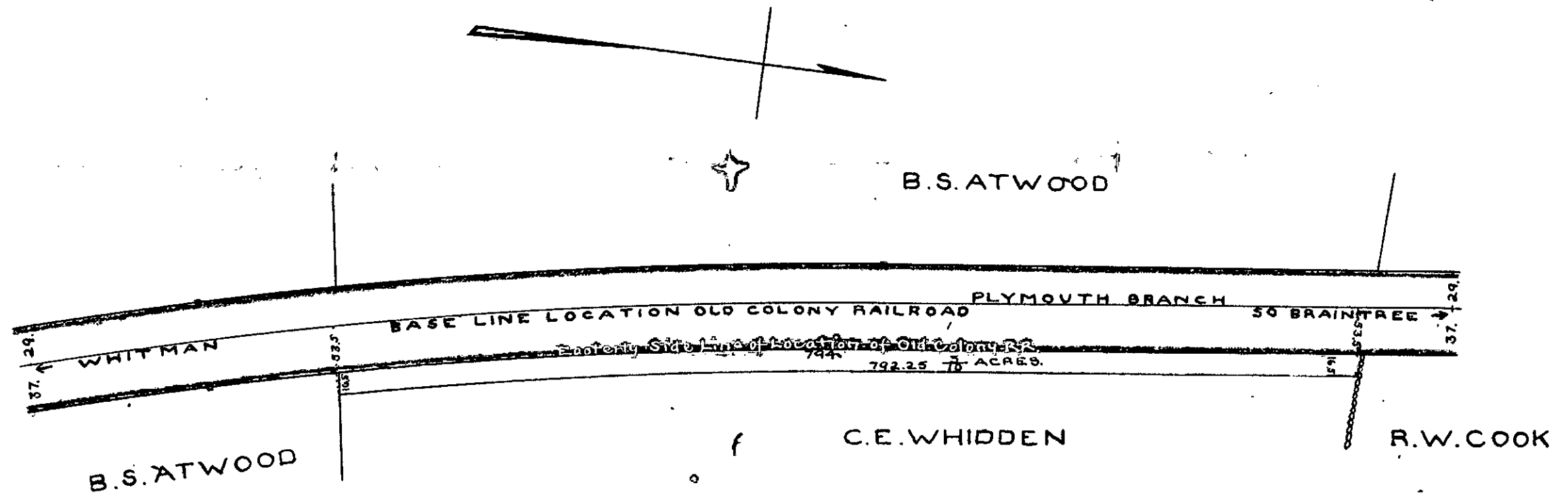

PLAN OF LAND IN WHITMAN MASS.
CONVEYED BY
CORDELIA E. WHIDDEN
TO THE
OLD COLONY RAILROAD CO
 SCALE - 1" = 100' NOV-1908

W. L. ...

W. L. ...

W. L. ...

W. L. ...

