

PLAN OF LAND IN HANOVER MASS.
 NEAR CURTIS CROSSING STATION
 TO BE CONVEYED TO THE
 OLD COLONY RAILROAD COMPANY
 BY
 CARRIE J. BISHOP
 SCALE 100' JULY 1907.

Handwritten signature

AUG 24 1907

E-21-3331

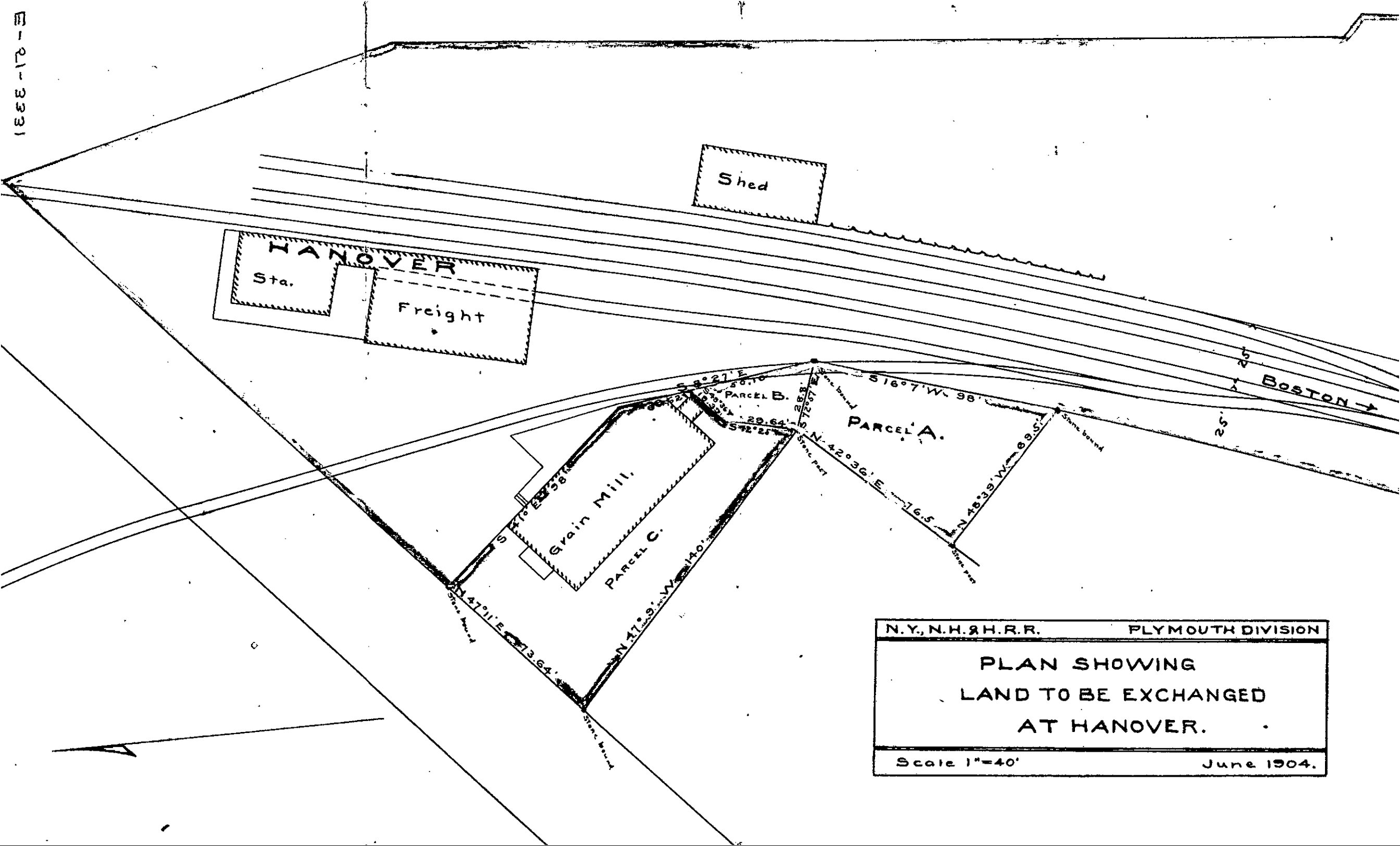

N.Y. N.H. & H.R.R. PLYMOUTH DIVISION

PLAN SHOWING
LAND TO BE EXCHANGED
AT HANOVER.

Scale 1"=40' June 1904.

W. H. S.

Harvard

2

NOV 14 1904